



E-IM-2925

ENGLISH **EN**  
BAHASA INDONESIA **IN**

## Before Starting

ENGLISH

- Before using this product, please read this manual carefully. Please keep it for future reference.
- Remove the insulation tape at the back of calculator and press [RESET] button before use. (figure 3)
- Turns power on. (figure 6)

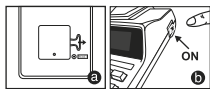

## General Maintenance

- Do not use or leave the calculator under direct sunlight. Areas subject to rapid temperature changes, high humidity, dust and dirt should also be avoided.
- Use a dry cloth to clean the casing of the unit. Do not use water or detergents.
- Activate the printer only when the paper roll is loaded.
- Avoid using the calculator in places where there are iron filings, as this may affect the electrical circuits of the calculator.
- Do not place anything on top of the machine, particularly on top of the printer mechanism.
- Turn the calculator off before removing the plug from the electrical outlet.
- Pull the main plug to the wall socket if you want to switch off the main power or in case of electrical fault (i.e. smoke), disconnect the plug from the electrical socket-outlet immediately.
- The AC outlet must be located near the equipment and easily accessible.
- Under the environment with electrostatic discharge, the sample may malfunction and require user to reset the sample.

## Replacing the Ink Ribbon

- Note:** Turn the power switch off. (Figure 1)
- 1) Lift up the tab on the back-side of the printer cover, and then remove the cover. (Figure 2)
  - 2) While pinching together the ribbon lock (A) in the direction of arrow, lift ribbon spools off the shafts. Discard the old ribbon and spools. (Figure 3)
  - 3) Separate the spools of new ribbon between the tape and printer head. Guide it around the four positions of the ribbon guide (B) and place the spools on the shafts. (Figure 4)
  - 4) When the ribbon spools have settled, release the ribbon locks. If necessary, rotate the spools until the pegs on the bottom of the spool seat themselves in the holes of the spool holder. (Figure 5)
  - 5) Rotate either spool to take up any ribbon slack, making sure that the ribbon is positioned around the four ribbon guides. Replace the printer cover. (Figure 6)

### IMPORTANT: Use only the same type of ribbon spools.

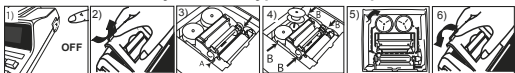

## Inserting Printing Paper

- 1) Lift up the paper arm. (Figure 7)
- When inserting the paper, cut the edge of the paper as Figure 8.
- Suitable paper roll – Width: 57 mm / Diameter: max. 86 mm
- Paper – standard paper 45kg/ 1000 sheets/ 788 x 1091 mm
- 2) Place the new paper roll on the arm. The edge of the paper should be positioned as shown (Figure 9)
- 3) Insert the paper into the slit located at the top of the machine as indicated (Figure 10).
- 4) Turn the power switch on. Press the paper feed key **[↑]** to advance the paper. (Figure 11)

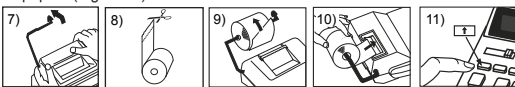

## Decimal Point Selector Switch

- Used for designating the decimal point position (+, 0, 2, 3, 4, 6, F) for calculated results.
- **+** (Add-Mode): Addition and subtraction functions are performed with an automatic 2-digit decimal. It is convenient for currency calculations.
- **F** (Floating Decimal Point): All effective numbers up to 14 digits are printed or displayed.



## Rounding Switch

- Used for round-up [**↑**], round-off (4/5), or round-down [**↓**] to the pre-selected decimal digits in the result.

## Print Switch

- Entries and results will appear on the display, but will not be printed out.
- Entries and results will appear on the display, but will be printed out.

## Item Count Switch

- At "n+" or "n+/-" position, the calculator count and print the number of calculation items up to 999.
- **<ITEM COUNT>** When the "ITEM" switch is set at "n+", the calculation counts the number of times the **[+]** and **[=]** keys are pressed. When the switch is set at "n+/-", the calculator counts the number of times the **[+]** key is pressed and subtracts from the total numbers of times the **[=]** is pressed.
- **<MEMORY ITEM COUNT>** When the "ITEM" switch is set at "n+", the calculation counts the number of times **[M+]** and **[M-]** keys are pressed. When the switch is set at "n+/-", the calculator counts the number of times the **[M+]** key is pressed and subtracts from the total number of times the **[M+]** is pressed.
- **<PRINTOUT OF ITEM COUNT>** When the PRINT switch is turned "ON", and the "ITEM" switch is at the "n+" or "n+/-" position, the number of times recorded by the counter can print up to three digits on the left-hand side of the paper by pressing either the **[Z]** key or the **[X]** key for item count and **[M+]** key or **[M-]** key for memory item count.

## Grand Total / Tax Rate Set Switch

- When the calculations are performed with the GT switch set to "ON", the totals are accumulated in the grand total memory. Each time **[X]** is pressed, the subtotal number is printed with the symbols GT. When **[GT]** is pressed, the intermediate grand total is printed with the symbols G $\downarrow$ . Press **[GT]** successively to get the grand total followed by the symbols G $\times$ .
- Set switch to "TAX RATE SET" for setting or recalling the TAX rate.

## Overflow

- In the following cases, "E" is displayed, • ERR • is printed, the keyboard is electronically locked, and further operation is impossible. Press **[SE]** to clear the overflow. The overflow function occurs when:
1. The result or the memory content exceeds 14 digits to the left of the decimal point.
  2. Dividing by "0".
  3. The sequential operation speed is faster than the calculation processing speed. (Buffer Register Overflow)

- Electromagnetic interference or electrostatic discharge may cause the display to malfunction or the memory currency rate and tax rate to be lost or altered. Should this occur, use the tip of a ballpoint pen (or similar sharp object) to press the [RESET] button on the back of the calculator. After resetting be sure to set the currency rate and tax rate again.

## Specifications

Power source: AC100V – 240V, 50/ 60Hz  
Operation Temperature: 0°C – 40°C  
Calculation Capacity: 14 digits maximum  
Dimension: 334 mm (W) x 219 mm (L) x 74.5mm (H)  
Weight: 1.6 kg  
(Subject to change without notice)

## Backup Battery

- Memory backup battery retains the currency rate and tax rate, even if the power is off or the AC cords is disconnected.  
Battery: 1 Lithium battery (Type: CR2032)  
Battery life: Backup time 3 years
- **Caution:** Risk of explosion if battery is replaced by an incorrect type dispose of used batteries according to instruction. Dispose of batteries according to local regulations. Do not dispose as household waste.

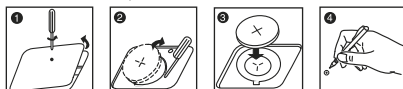

After replace the back-up battery, press the [RESET] button. After resetting be sure to set the currency rate and tax rate again.

## BAHASA INDONESIA

## Baca Sebelum Menggunakan

- Sebelum menggunakan produk ini, silahkan baca petunjuk ini dengan seksama. Mohon disimpan untuk referensi.
- Lepaskan pita insulasi di belakang kalkulator dan tekan tombol [RESET] sebelum digunakan. (Gambar 3)
- Aktifkan daya. (Gambar 6)

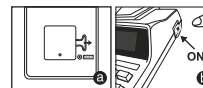

## Perawatan Umum

- Jangan gunakan atau biarkan kalkulator di bawah sinar matahari langsung. Mesin pencetak tunduk pada perubahan suhu yang cepat. Kelembapan yang tinggi, debu dan kotoran juga harus dihindari.
- Gunakan kain kering untuk membersihkan tutup (casing) kalkulator. Jangan gunakan air atau detergen.
- Aktifkan pencetak ketika kertas rol sudah dipasang.
- Hindari penggunaan kalkulator di tempat-tempat di mana ada kikiran besi karena dapat memengaruhi sirkuit listrik kalkulator.
- Jangan taruh apa pun di atas kalkulator, khususnya di atas mekanisme pencetak.
- Matikan kalkulator sebelum mencabut kabel dari aliran listrik.
- Tarik keluar kabel utama dari soket dinding jika Anda ingin mematikan daya utama atau apabila terjadi kerusakan listrik (misalnya timbul asap). Cabut segera sambungan dari soket listrik arus bolak-balik (AC).
- Soket arus bolak-balik (AC) harus ditempatkan dekat dengan peralatan ini dan mudah diakses.
- Di lingkungan dengan pengosongan elektrostatik, contoh mungkin salah dan pengguna diminta untuk menyetel ulang contoh.

## Mengganti Pita Tinta

- Catatan:** Matikan daya (Gambar 1)
- 1) Angkat tab di bagian belakang tutup pencetak, kemudian lepaskan tutup itu. (Gambar 2)
  - 2) Ketika menjepit serentak pengunci pita (A) ke arah panah, angkat rol pita ke luar dari porosnya. Buang pita dan rol yang lama. (Gambar 3)
  - 3) Pisahkan rol pita baru di antara pita dan kepala pencetak (printer head). Bawa ke empat posisi pengarah pita (B) dan taruh rol di dalam poros. (Gambar 4)
  - 4) Apabila rol pita sudah terpasang, buka pengunci pita. Jika perlu, putar rol hingga pasak-pasak di bagian bawah dudukan rol berada di dalam lubang-lubang penyangga rol itu. (Gambar 5)
  - 5) Putar kedua rol untuk mengencangkan kendurannya, memastikan bahwa pita berada di keempat pengarah pita. Taruh kembali tutup pencetak. (Gambar 6)

### PENTING: Hanya gunakan rol pita yang sama jenis.

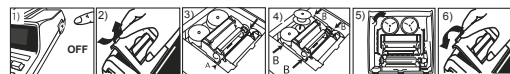

## Menasukkan Kertas Cetak

- 1) Angkat sandaran kertas. (Gambar 7)
- Ketika memasukkan Kertas, potong ujung kertas seperti pada Gambar 8.
- Gulungan kertas yang sesuai – Lebar: 57 mm  
Diameter: maksimum 86 mm
- 2) Taruh gulungan kertas baru di sandaran kertas. Ujung kertas harus dilettakkan seperti yang ditunjukkan. (Gambar 9)
- 3) Masukkan kertas ke dalam celah yang ada di belakang mesin seperti yang ditunjukkan. (Gambar 10)
- 4) Hidupkan tombol daya . Tekan tombol pengisi kertas **[↑]** untuk menaikkan kertas. (Gambar 11)

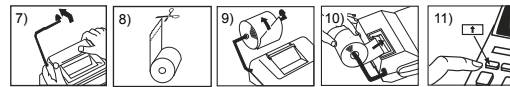

## Tombol Pemilih titik Desimal

- Digunakan untuk menentukan posisi titik desimal (+, 0, 2, 3, 4, 6, F) untuk hasil perhitungan.
- **+** (Mode-Tambah): fungsi penambahan dan pengurangan dilakukan dengan 2 titik desimal. Hal ini baik untuk kalkulasi mata uang.
- **F** (Titik Desimal Kambang): semua angka efektif hingga 14 digit dicetak atau ditampilkan.

## Tombol Pembulatan

- Digunakan untuk pembulatan ke atas [**↑**], pembulatan (4/5), atau pembulatan ke bawah [**↓**] terhadap digit desimal yang dipilih sebelumnya di dalam hasil.



## Tombol Cetak

### CETAK TIDAK AKTIF

- Entri dan hasil akan muncul dalam tampilan, tetapi tidak akan dicetak.



### CETAK AKTIF

- Entri dan hasil akan muncul dalam tampilan dan akan dicetak.

## Tombol Jumlah Item

- Pada posisi "n+" atau "n+/-", kalkulator menghitung dan mencetak jumlah kalkulasi item hingga 999.
- **<PENGHITUNG ITEM>** Apabila tombol "ITEM" disetel pada "n+", kalkulator menghitung berapa kali tombol **[+]** dan **[=]** ditekan. Apabila tombol disetel pada "n+/-", kalkulator menghitung berapa kali tombol **[+]** ditekan dan mengurangi dari total berapa kali tombol **[=]** ditekan.
- **<PENGHITUNG ITEM MEMORI>** Apabila tombol "ITEM" disetel pada "n+", kalkulator menghitung berapa kali tombol **[M+]** dan **[M-]** ditekan. Apabila tombol "ITEM" disetel pada "n+/-", kalkulator menghitung berapa kali tombol **[M+]** ditekan dan mengurangi dari total berapa kali tombol **[M+]** ditekan.
- **<HASIL CETAK JUMLAH ITEM>** Apabila tombol "CETAK", diaktifkan dan tombol "ITEM" berada pada posisi "n+" atau "n+/-", jumlah item yang disimpan oleh penghitung dapat dicetak hingga tiga digit di sisi kiri kertas dengan menekan baik tombol **[Z]** maupun tombol **[X]** untuk jumlah item dan tombol **[M+]** atau tombol **[M-]** untuk jumlah item memori.

## Nilai Total / Tombol Pengaturan Tarif Pajak

### NILAI TOTAL

- Ketika kalkulasi dilakukan dengan tombol nilai total (GT) "AKTIF", angka total diakumulasikan di dalam memori nilai total. Setiap kali **[X]** ditekan, angka subtotal dicetak dengan simbol GT. Apabila **[GT]** ditekan, nilai total antara dicetak dengan simbol G $\downarrow$ . Tekan **[GT]** secara berturut-turut untuk mendapatkan nilai total diikuti dengan simbol G $\times$ .

### PENGATURAN TARIF PAJAK

- Atur tombol ke "ATUR TARIF PAJAK" untuk menetapkan atau memanggil balik tarif pajak.

## Limbah Atas

- Dalam hal-hal berikut, apabila "E" ditampilkan, • ERR • dicetak, papan tombol terkunci secara elektronis dan operasi lebih lanjut tidak dapat dilakukan.
- Tekan **[SE]** untuk menghapus limbah atas. Limbah atas terjadi ketika:
1. Hasil atau isi memori lebih dari 14 digit ke sebelah kiri titik desimal.
  2. Membagi "0".
  3. Kecepatan operasi berurutan lebih cepat dari kecepatan proses kalkulasi (Register Penyangga Limbah Atas).

- Gangguan elektromagnetik atau pengosongan elektrostatik dapat menyebabkan mala fungsi tampilan atau hilangnya atau berubahnya memori, nilai tukar mata uang dan tarif pajak. Apabila ini terjadi, gunakan ujung bolpoin (atau benda tajam serupa) untuk menekan tombol "RESET" di bagian belakang kalkulator. Setelah melakukan reset, pastikan untuk menetapkan kembali kalender, jam dan tarif pajak.

## Spesifikasi

Sumber Daya: AC 100V – 240V, 50/ 60Hz  
Suhu Operasi: 0°C - 40°C  
Kapasitas Kalkulasi: Maksimum 14 digit  
Dimensi: 334 mm (panjang) X 219 mm (lebar) X 74.5 mm (tinggi)  
Berat: 1.6 kg  
(Tunduk pada perubahan tanpa pemberitahuan)

## Baterai Cadangan

- Baterai cadangan memori menyimpan tarif pajak, pengaturan kalender dan jam, bahkan jika daya mati atau kabel listrik dicabut.  
Baterai : 1 baterai Lithium (Tipe CR2032)  
Umur baterai : 3 tahun

- **PERINGATAN:** Risiko ledakan jika baterai diganti dengan jenis yang tidak sesuai. Buang baterai bekas sesuai petunjuk. Buang baterai sesuai dengan aturan lokal. Jangan buang sebagai limbah rumah tangga.

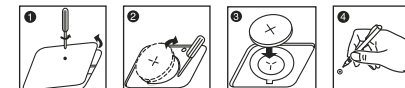

Setelah mengganti baterai cadangan, tekan tombol [RESET]. setelah melakukan pengaturan ulang untuk menetapkan mengatur tarif pajak, jam, dan kalender lagi.

**CALCULATION EXAMPLE / CONTOH KALKULASI**

**EN** If switches on your calculator do not match the example below, please set switches as shown.

**IN** Jika tombol-tombol dalam kalkulator Anda tidak sesuai dengan contoh-contoh di bawah ini, harap atur tombol-tombol seperti yang ditunjukkan.



Calculation	Operation	Print Out
2+(3x4)-5=9	2 [SE] [X] [4] [=]	0. C 2.00 x 3. x 4. = 12.00 * 12.00 + 5.00 + 9.00 *
-2x3=-6	2 [SE] [X] [3] [=]	2.00 - 2.00 x 3. = 6.00 *
3 <sup>3</sup> = 27	3 [SE] [X] [3] [=]	0. C 3. x 3. = 9.00 * 9.00 x 27.00 *
1/7 = 0.1428571428751	1 [DECIMAL] [7] [=]	7. ÷ 7. = 1.000 * 1.000 * 0.143 *
\$12.55+\$15.75-\$5.30-\$5.30=\$23.00	1255 [SE] [530] [SE] [530] [=]	12.55 + 15.75 + 5.30 - 23.00 *
8÷3x3.7+9=18.8666666666666	8 [SE] [3] [SE] [3] [SE] [7] [SE] [9] [=]	8. ÷ 3. x 3.7 + 9.8666666666664 * 9.8666666666664 * 9. + 18.866666666666 *
123 x 756 - 456 = 56,088	123 [SE] [756] [SE] [456] [=]	123. x 456. = 56,88.00 *
123 x 455 - 6 = 56,088	123 [SE] [455] [SE] [6] [=]	123. x 456. = 56,080.00 *

**Percentage Calculation / Kalkulasi Persentase**

2000+(2,000x12%)=2,240	2000 [X] [12] [%] [=]	2,000. x 12. % 240.00 * 2,240.00 +%
2000-(2,000x15%)=1,700	2000 [X] [15] [%] [=]	2,000. x 15. % 300.00 * 1,700.00 -%

**Data Printout / Hasil Cetak Data**

Date	Value	Print Out
12 Jun. 2015	1860	#12.6.2015 1,860.00 + 1,420
13 Jun. 2015	2380	#13.6.2015 2,380.00 + 2,200
	7,860	2,200.00 + 7,860.00 *

**Grand Total Calculation / Kalkulasi Nilai Total**

123 + 456 = 579	123 [SE] [456] [=]	123.00 + 456.00 + 579.00 GT
+ 488 - 390 = 98	488 [SE] [390] [SE] [=]	488.00 + 390.00 - 98.00 GT
+ 655 + 188 = 843	655 [SE] [188] [=]	655.00 + 188.00 + 843.00 GT
1,520	1520 [GT] [=]	1,520.00 G◇ 1,520.00 G*

**Item Counting Calculation / Jumlah Item**

1,860 ... 1)	1860 [SE] [1] [=]	1,860.00 + 1,420 ... 2)	1420 [SE] [2] [=]	1,420.00 + 2,380 ... 3)	2380 [SE] [3] [=]	2,380.00 + 1,475 ... 4)	1475 [SE] [4] [=]	1,475.00 + 5,660	5660 [GT] [=]	5,660.00 *
--------------	-------------------	----------------------------	-------------------	----------------------------	-------------------	----------------------------	-------------------	---------------------	---------------	------------

**Memory Calculation / Kalkulasi Memori**

243 x 2 = 486	243 [SE] [2] [=]	243. x 2. = 486.00 M+
+ 576 x 5 = 2,880	576 [SE] [5] [=]	576. x 5. = 2,880.00 M+
3,366	3366 [M+] [=]	3,366.00 M◇
-) 75 + 103 = 178	75 [SE] [103] [SE] [=]	75.00 + 103.00 + 178.00 *
3,188	3188 [M+] [=]	3,188.00 M◇ 3,188.00 M*

**Cash Change Calculation / Kalkulasi Uang Kembali**

Purchase price: \$250	250 [SE] [250] [=]	250.00 + \$300	300.00 + \$270	270.00 + \$820	820.00 *
Cash paid: \$1,000	1000 [CHANGE] [=]	1000.00 CC Change price = ? (\$180)	180.00 ΔC		

**Cash Change with Memory Calculation / Uang Kembali dengan Kalkulasi Memori**

Purchase price: \$1,770	1770 [M+] [M+] [=]	1,770.00 M+ 1,770.00 M◇	
Cash paid: \$1,800	1800 [CHANGE] [=]	1,800.00 CC Change price = ? (\$30)	30.00 ΔC
Cash paid: \$2,000	2000 [CHANGE] [=]	2,000.00 CC Chanbe price = ? (\$230)	230.00 MC 1,770.00 M*

**Currency Conversion Calculation / Kalkulasi Konversi Mata Uang**

**Store the Currency Rate / Menyimpan Nilai Tukar Mata Uang**

**EN** Press [C1] and hold for 1 second, then enter the currency conversion rate and press [C1] or [C2] to store the rate.

**IN** Tekan [C1] dan tahan selama 1 detik, kemudian masukkan nilai tukar konversi mata uang dan tekan [C1] atau [C2] untuk menyimpan nilai tukar.

**Recall the Currency Rate / Memanggil Kembali Nilai Tukar Mata Uang**

**EN** Press [C1] or [C2] to recall the stored currency conversion rate.

**IN** Tekan [C1] atau [C2] untuk memanggil balik nilai tukar mata uang yang disimpan.

**LOCAL Key / Kunci**

**EN** Press [LOCAL] to convert currency figure displayed from [C1] or [C2] to the [LOCAL].

**IN** Tekan [LOCAL] untuk mengonversi angka mata uang yang ditampilkan dari [C1] atau [C2] menjadi [LOCAL].

**[C1] or/atau [C2] Key / Kunci**

**EN** Press [C1] or [C2] to convert displayed figure from [LOCAL] to [C1] or [C2].

**IN** Tekan [C1] atau [C2] untuk mengonversi angka mata uang yang ditampilkan dari [LOCAL] menjadi [C1] atau [C2].

**EN** \*1 Specifying the Number of Decimal Places for Intermediate Local Currency Amounts. When you convert from one national currency to another, the calculator internally converts the original currency to Local Currency. This conversion result is the "intermediate Local Currency amount". Next, the intermediate Local Currency amount is converted to the target currency. The flow of the steps of the conversions will be shown on the printout. For such a calculation, you should use the following procedure to specify the number of decimal places for the intermediate Local Currency amount. You can specify from 0 (0<sup>2</sup>), 2, 3, 4 and 6 decimal places, for a floating decimal point (F). The intermediate Local Currency amount is rounded off to the number of decimal places you specify.

\*2 0 is displayed when F (floating point) is set for the number of decimal places. F is the initial default setting.

\*3 For rates of 1 or greater, you can input up to six digits. For rates less than 1 you can input up to 8 digits, including 0 for the integer digit and leading zeros (though only 6 significant digits, counted from the left and starting with the first non-zero digits, can be specified).

**IN** \*1 Menentukan Jumlah Tempat Desimal untuk Jumlah Antara Mata Uang Lokal. Ketika Anda mengonversi mata uang satu negara dengan mata uang negara lain, secara internal kalkulator mengonversi mata uang asal ke Mata Uang Lokal. Hasil konversi ini adalah "Jumlah Antara Mata Uang Lokal". Selanjutnya, Jumlah Antara Mata Uang Lokal dikonversi ke mata uang target. Alur langkah-langkah konversi akan ditunjukkan di hasil cetak. Untuk kalkulasi semacam ini, Anda harus menggunakan prosedur berikut untuk menetapkan tempat desimal untuk jumlah antara Mata Uang Lokal. Anda dapat menentukan dari 0 (0<sup>2</sup>), 2, 3, 4 dan 6 tempat desimal, untuk titik desimal kambang. Jumlah antara Mata Uang Lokal dibulatkan ke jumlah tempat desimal yang Anda tetapkan.

\*2 0 ditampilkan ketika F (titik kambang) disetel untuk jumlah tempat desimal. F adalah pengaturan default awal.

\*3 Untuk nilai tukar 1 atau lebih besar, Anda dapat memasukkan hingga 6 digit. Untuk nilai tukar kurang dari 1, Anda dapat memasukkan hingga 8 digit, termasuk 0 untuk digit bilangan bulat dan angka nol di depan (meski hanya tujuh digit signifikan, dihitung dari kiri dan dimulai dari digit bukan nol yang pertama, dapat ditentukan).

**Set Currency Rate**

Local = 1 (Euro)  
C1 = 1.45 (US\$)  
C2 = 0.7 (€)

**Convert Currency**

Euro 35 = US\$ ?  
(US\$50.75)

£58 = Euro ? (€82.86)

US\$58 = £ ?  
US\$58 = Euro 40 = £ 28

**Recall Currency Rate**

0. C	0. C
1.45 C1	1.45 C1
0. C	0. C
0.7 C2	0.7 C2
0. C	0. C
35 LOCAL	35. L
1.45 C1	1.45 C1
50.75 *	50.75 *
58. C2	58. C2
LOCAL	82.86 L*
0. C	0. C
58 C1	58. C1
1.45 *	1.45 *
40. L	40. L
0.7 C2	0.7 C2
28.00 *	28.00 *
0. C	0. C
1.45 C1	1.45 C1
0. C	0. C
0.7 C	0.7 C

**Business sales calculation / Kalkulasi Penjualan Usaha**

**EN** Used for calculating the cost, selling price and profit margin amount. Enter the value of any 2 items to obtain the balance value item. (e.g. enter the value of the cost and the selling price to obtain the profit margin %.)

**IN** Digunakan untuk menghitung biaya, harga jual, dan nilai margin laba. Masukkan nilai 2 item mana pun untuk mendapatkan item nilai saldo. (Misalnya masukkan nilai biaya dan harga jual untuk mendapatkan % margin laba).

**Calculating Cost**

Selling price: \$2,000  
Profit Margin: 30%  
Cost = ? (\$1,400)

**Calculating Selling Price**

Cost: \$1,500  
Profit Margin: 20%  
Selling price = ? (\$1,875)

**Calculating Profit Margin**

Cost: \$1,500  
Profit Margin: \$2,000  
Selling price = ? (25%)

2000 [SELL]	2,000. S *
30 [MARGIN]	30. M %
	1,400.00 C *
1500 [COST]	1,500. C *
20 [MARGIN]	20. M %
	1,875.00 S *
1500 [SELL]	1,500. C *
20 [COST]	2,000. S *
	25.00. M %

**Tax Calculation / Kalkulasi Pajak**

**TAX+ Add tax key:** Used for adding the tax amount to the displayed figure.

**TAX- Deduct Tax key:** Used for deducting the tax amount from the displayed figure.

**IN Tombol Tambah Pajak:** Digunakan untuk menambahkan jumlah pajak ke angka yang ditampilkan.

**Tombol Kurangi Pajak:** Digunakan untuk mengurangi jumlah pajak dari angka yang ditampilkan.

**Set Tax Rate**

Tax Rate = 5%

**Add the Tax Amount**

Price \$2,000 without tax  
Tax = ? (\$100)  
Selling Price with tax = ? (\$2,100)

**Deduct the Tax Amount**

Selling Price \$3,150 with tax  
Tax = ? (\$150)  
Price without tax = ? (\$3,000)

**Chage Tax Rate**

Tax Rate = 10%

0. %	0. %
5. %	5. %
2000 [TAX+]	2,000.
	5. %
100.00 Δ+	100.00 Δ+
2,100.00 *	2,100.00 *
3150 [TAX-]	3,150.
	5. %
150.00 Δ-	150.00 Δ-
3,000.00 *	3,000.00 *
5. %	5. %
10. %	10. %

**Overflow / Lumpah Atas**

1) 55,000,000,000,000  
x) 2,300  
-----  
1265000000000000000  
(Error)

2) 6 ÷ 0 = 0  
(Error)

55,000,000,000,000	55000000000000	55,000,000,000,000 x
2,300	2300	2,300 =
		• ERR •
		1,265,000,000,000,000 *
		0. C
6 ÷ 0 = 0	6 ÷ 0 = 0	6. ÷
(Error)	(Error)	0. =
		• ERR •
		0. *
		0. C

**CANON ELECTRONIC BUSINESS MACHINES (H.K.) CO., LTD.**  
17/F., Tower One, Ever Gain Plaza, 82-100 Container Port Road, Kwai Chung, New Territories, Hong Kong

**CANON MARKETING (MALAYSIA) SDN BHD.**  
Block D, Peremba Square, Saujana Resort, Section U2, 40150 Shah Alam, Selangor Darul Ehsan, Malaysia

Made in China / Buatan Cina  
Printed in China / Tercetak di China  
© CANON ELECTRONIC BUSINESS MACHINES (H.K.) CO., LTD. 2015

E-IM-2925