

INSTRUCTIONS / INSTRUKSI



E-IM-2932

ENGLISH
BAHASA INDONESIA

ENGLISH

- Before using this product, please read this manual carefully. Please keep it for future reference.

POWER SUPPLY

This calculator comes with an alkaline battery power source. The duration of alkaline battery depends on individual usage.

- Electromagnetic interference or electrostatic discharge may cause the display to malfunction or the contents of the memory to be lost or altered. Should this occur, press the key and re-start your calculation from the beginning.

OVERFLOW FUNCTION

In the following cases, when error message "E" is display, the keyboard is electronically locked, and further operation is impossible. Press to clear the overflow. The overflow function occurs when:

- The calculation result exceeds 8 digits to the left of the decimal point.
- Dividing by "0".

SPECIFICATION

Power Source: Alkaline battery (LR44 x 1)
Auto-power: Approx. 7 minutes
Operating Temperature: 0°C to 40°C
Dimensions: 75mm (L) x 42mm (W) x 13mm (H)
Weight: 28g
(Subject to change without notice)

- Sebelum menggunakan produk ini, silahkan baca petunjuk ini dengan seksama. Mohon disimpan untuk referensi.

CATU DAYA

Kalkulator ini dilengkapi dengan sumber daya baterai alkali. Umur baterai alkali hanya tergantung pada penggunaan masing-masing.

- Interferensi elektromagnetik atau terkena sengatan listrik dapat menyebabkan layar untuk rusak atau isi memori yang akan hilang atau berubah. Jika ini terjadi, tekan tombol kunci dan restart perhitungan Anda dari awal.

FUNGSI OVERFLOW

Pada kasus berikut, pesan kesalahan "E" akan diperlihatkan pada tampilan. Papan ketik terkunci secara elektronik, dan operasi tidak mungkin dapat dilakukan lagi. Tekan untuk menghapus overflow. Overflow terjadi apabila:

- Hasil perhitungan melebihi 8 digit ke sebelah kiri titik desimal.
- Membagi dengan "0".





SPESIFIKASI

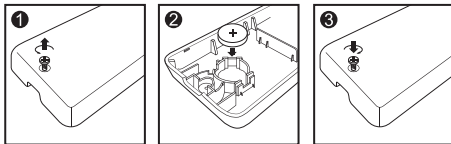

Sumber Daya: Baterai alkalin (LR44 x 1)
Catu Daya Mati Otomatis: lebih kurang 7 menit
Suhu Operasi: 0°C sampai 40°C
Dimensi: 75mm (L) x 42mm (P) x 13mm (T)
Berat: 28g
(Dapat berubah tanpa pemberitahuan)

REPLACING BATTERIES / MENGGANTI BATERAI



CALCULATION EXAMPLES / PERHITUNGAN CONTOH

Calculation / Perhitungan 	Operation / Operasi 	Display / Tampilan 
▼ Mixed / Campuran 		
$2 \times 2 = 6$	$2 \times 2 = 6$	(0.)
$-7 \times 9 = -63$	$7 \times 9 = 63$	(6.)
$(2+4) \div 3 \times 8.1 = 16.2$	$7 \times 9 = 63$	(- 63.)
	$2 \times 4 = 8$	(16.2)
	$8 \div 1 = 8$	(16.2)
	$9 \div 5 = 1.8$	(16.2)
	$1.8 \times 3 = 5.4$	(16.2)
	$5.4 + 7 = 12.76$	(12.76)
▼ Constant / Konstan		
$2 + 3 = 5$	$2 + 3 = 5$	(5.)
$4 + 3 = 7$	$4 + 3 = 7$	(7.)
$1 - 2 = -1$	$1 - 2 = -1$	(- 1.)
$2 - 2 = 0$	$2 - 2 = 0$	(0.)
$2 \times 3 = 6$	$2 \times 3 = 6$	(6.)
$2 \times 4 = 8$	$2 \times 4 = 8$	(8.)
$6 \div 3 = 2$	$6 \div 3 = 2$	(2.)
$9 \div 3 = 3$	$9 \div 3 = 3$	(3.)

▼ Percentage / Persen		
$200 + (200 \times 20\%) = 240$	$200 \times 20 \%$	(240.)
$200 - (200 \times 20\%) = 160$	$200 - 20 \%$	(160.)
▼ Overflow / Limpah Atas		
1) $123456 \times 7890 = 974067840$ (Error/Salah)	$123456 \times 7890 = 974067840$ 	(E 9.7406784)
2) $6 \div 0 = 0$ (Error/Salah)	$6 \div 0 = 0$ 	(E 0.)



WARNING / PERINGATAN

Collectible products not intended for children.

Produk Koleksi tidak dimaksudkan untuk anak-anak.

CANON ELECTRONIC BUSINESS MACHINES (H.K.) CO., LTD.
17/F., Tower One, Ever Gain Plaza, 82-100 Container Port Road,
Kwai Chung, New Territories, Hong Kong

CANON MARKETING (MALAYSIA) SDN BHD.
Block D, Peremba Square, Saujana Resort, Section U2,
40150 Shah Alam, Selangor Darul Ehsan, Malaysia